

FIGURE 1

LOCATION MAP

HCFC D PROJECT NO.: E500-21-00-E002
USACE PROJECT NO.: SWG-2017-00335



16340 Park Ten Place
Suite 350
Houston, Texas 77084
(713) 461-9600

TEXAS FIRM REGISTRATION NO. F-487

DATE: 12/12/2019

M:\3851 INWOOD FOREST STORMWATER DETENTION BASINS\3851_039 FINAL DESIGN\CD\EXHIBITS\EXHIBITS - OVERALL ENVIRONMENTAL.DWG | LARGE_FORMAT_BW.CTB | PLOTTED: 12/12/2019

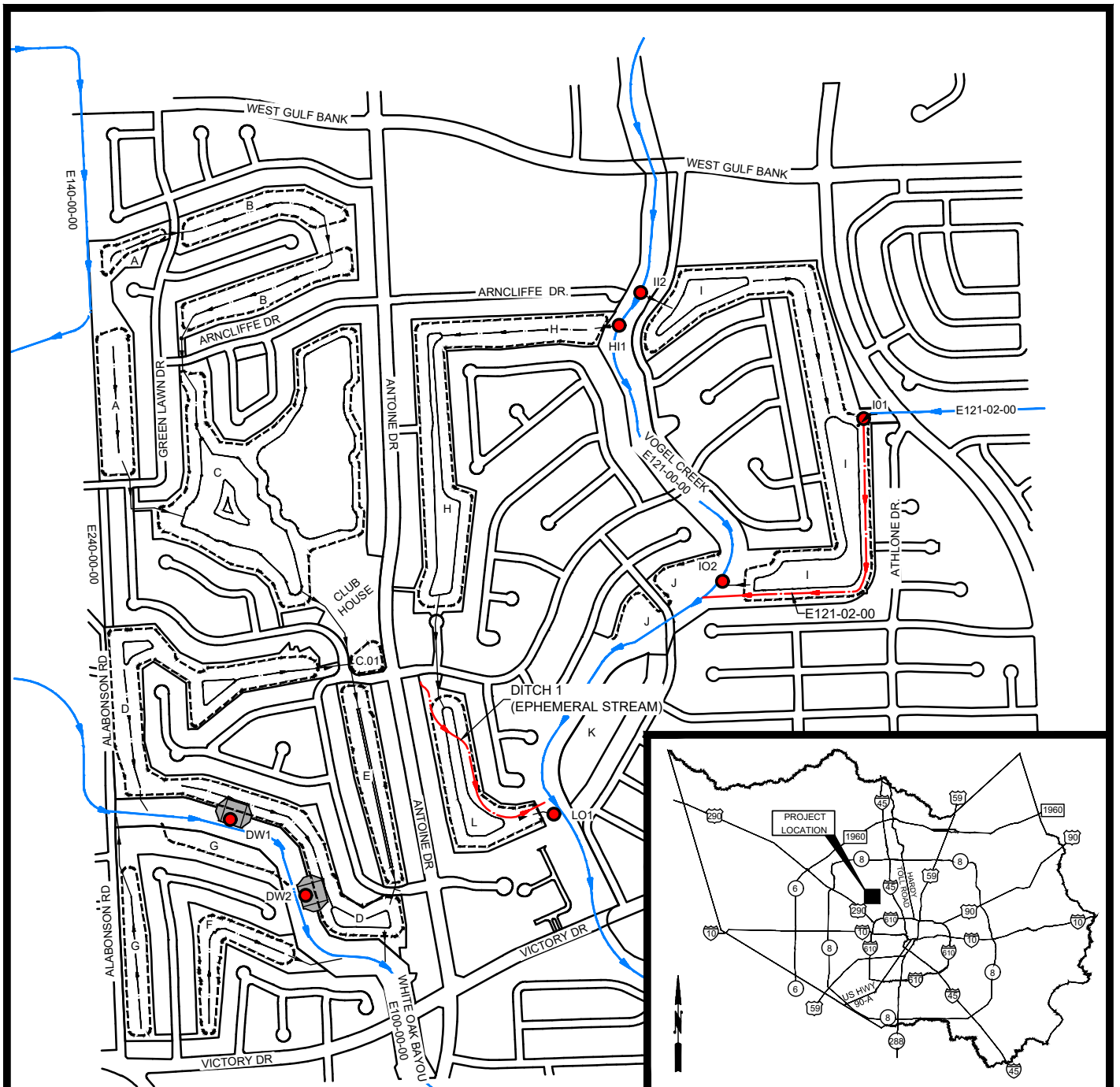

- ▶ IMPACTED STREAMS
- ▶ EXISTING STREAMS
- PROPOSED OUTFALL AND/OR INFLOW STRUCTURES

FIGURE 2

OVERVIEW MAP

HCFC PROJECT NO.: E500-21-00-E002
USACE PROJECT NO.: SWG-2017-00335



16340 Park Ten Place
Suite 350
Houston, Texas 77084
(713) 461-9600

TEXAS FIRM REGISTRATION NO. F-487

DATE: 12/12/2019

M:\BSE1\INWOOD_FOREST STORMWATER DETENTION\BASIN\3851_030 FINAL DESIGN\CAD\EXHIBITS\USACE-EXIST CHANNEL & OUTFALL PROFILES.DWG | HCFCO & EXH1.CTB | PLOTTED: 12/12/2019

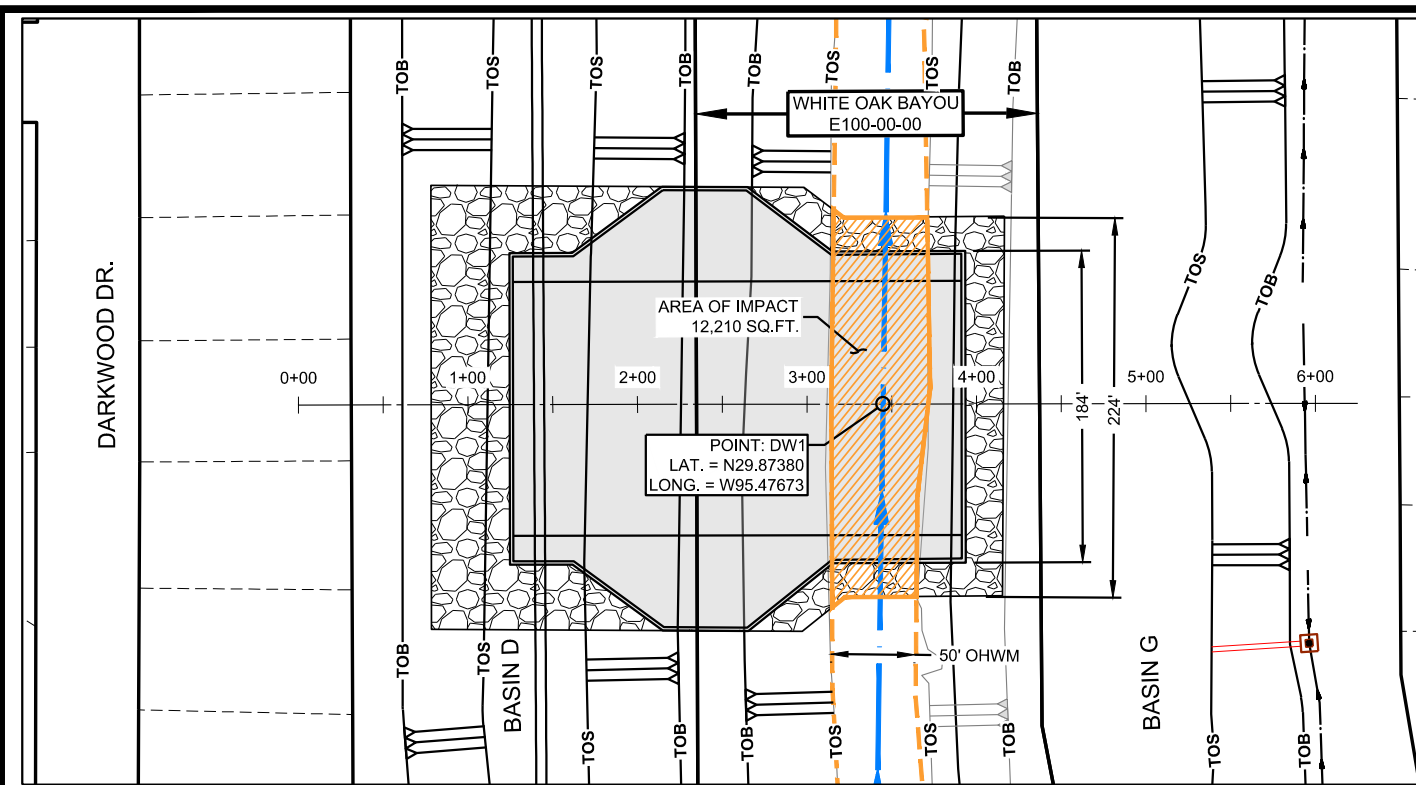

- LEGEND**
- ROW = RIGHT-OF-WAY
 - OHWM = ORDINARY HIGH WATER MARK
 - TOB = TOP OF BANK
 - TOS = TOE OF SLOPE
 - RESIDENTIAL LOTS
 - - - EXISTING GRADE
 - > STREAM CENTER LINE
 - - - OHWM LIMITS
 - ▨ FILL AREA UNDER OHWM
 - ▩ PROP. BURIED 18" RIPRAP
 - PROP. 5" CONCRETE

| Basin D Inflow Structure North | |
|--------------------------------|----------------------|
| Fill Volumes | |
| Material | Volume [cubic yards] |
| Concrete | 158 |
| Concrete Rip-Rap | 151 |
| Total Volume | 319 |

BASIN D INFLOW STRUCTURE (N)

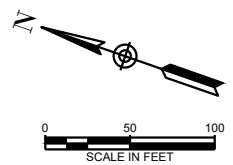
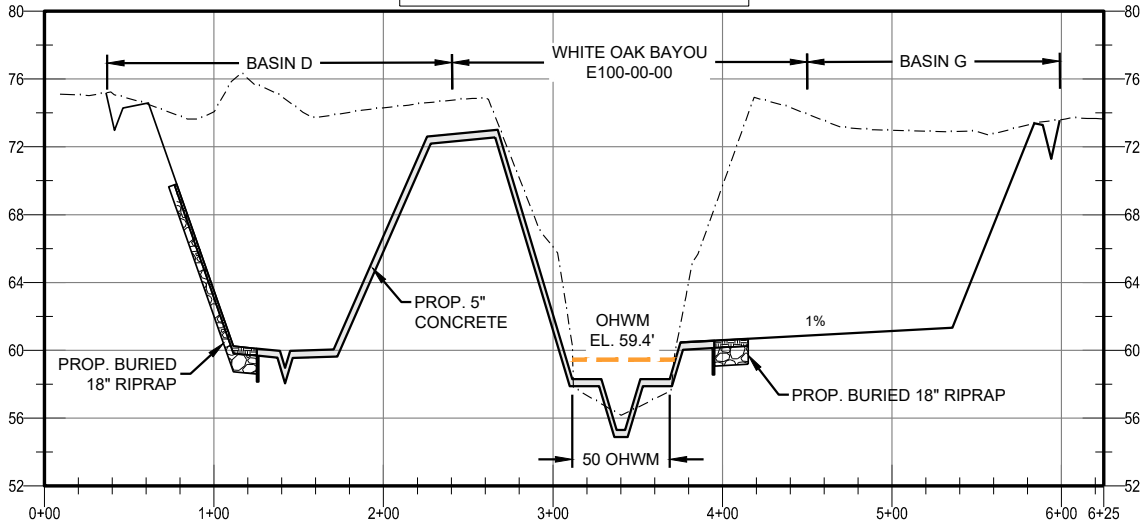

FIGURE 3
DW1 - BASIN D
(NORTH) INFLOW STRUCTURE
 PROPOSED CONDITIONS

HCFCO PROJECT NO.: E500-21-00-E002
 USACE PROJECT NO.: SWG-2017-00335

r.g.miller
engineers

16340 Park Ten Place
 Suite 350
 Houston, Texas 77084
 (713) 461-9800

TEXAS FIRM REGISTRATION NO. F-487
 DATE: 12/12/2019

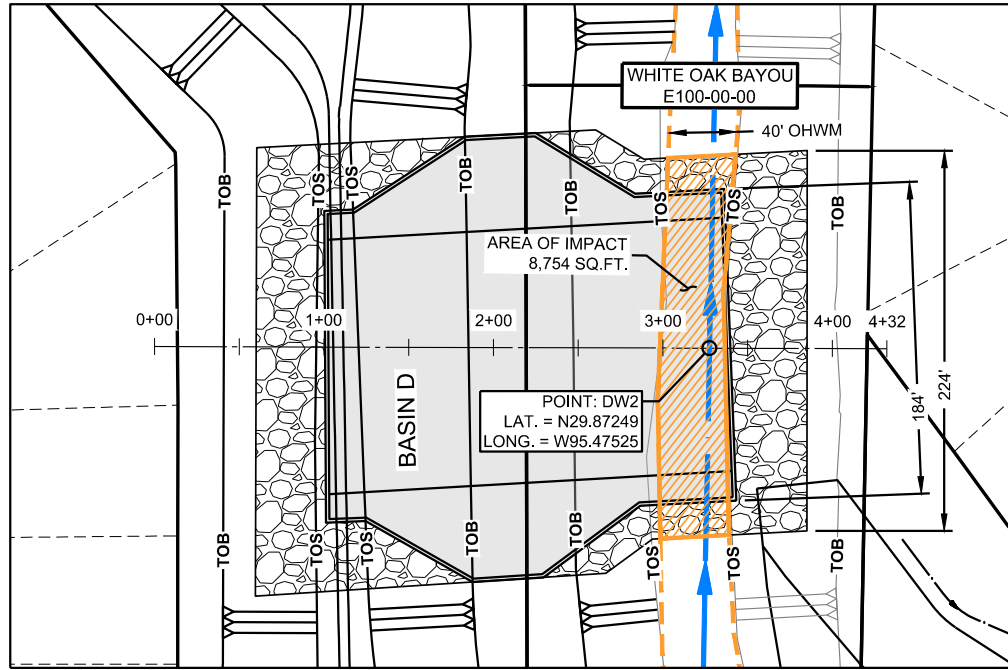

LEGEND

- ROW = RIGHT-OF-WAY
- OHWM = ORDINARY HIGH WATER MARK
- TOB = TOP OF BANK
- TOS = TOE OF SLOPE
- RESIDENTIAL LOTS
- - - EXISTING GRADE
- > STREAM CENTER LINE
- - - OHWM LIMITS
- ▨ FILL AREA UNDER OHWM
- ▨ PROP. BURIED 18" RIPRAP
- ▨ PROP. 5" CONCRETE

| Basin D Inflow Structure South | |
|--------------------------------|----------------------|
| Fill Volumes | |
| Material | Volume (cubic yards) |
| Clean Earth | 0 |
| Concrete | 111 |
| Concrete Rip-Rap | 128 |
| Total Volume | 239 |

BASIN D INFLOW STRUCTURE (S)

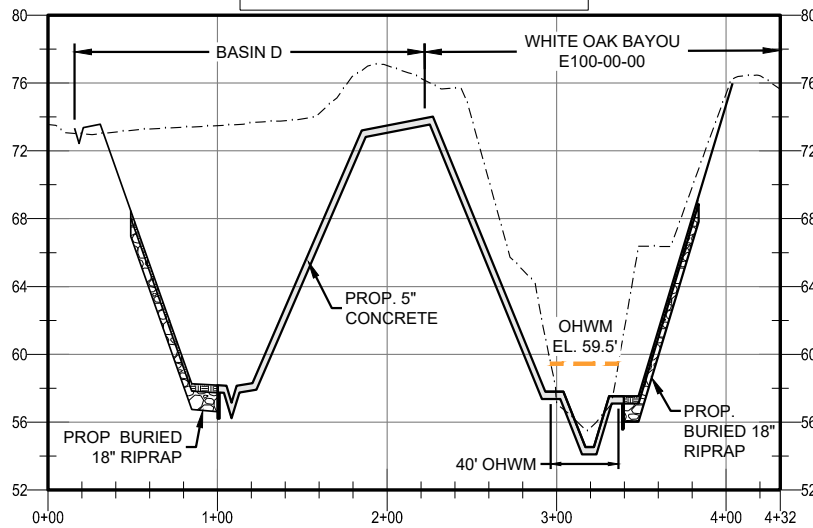

FIGURE 4
DW2 - BASIN D
(SOUTH) INFLOW STRUCTURE

PROPOSED CONDITIONS

HCFCO PROJECT NO.: E500-21-00-E002
USACE PROJECT NO.: SWG-2017-00335



16340 Park Ten Place
Suite 350
Houston, Texas 77084
(713) 461-9800

TEXAS FIRM REGISTRATION NO. F-487
DATE: 12/12/2019

M:\BSET\INWOOD FOREST STORMWATER DETENTION BASINS\3651_000_FINAL_DESIGN\CAD\EXHIBITS\USACE-EXIST CHANNEL & OUTFALL PROFILES.DWG | HCFC D & EXHIBIT 1.CTB | PLOTTED: 12/12/2019

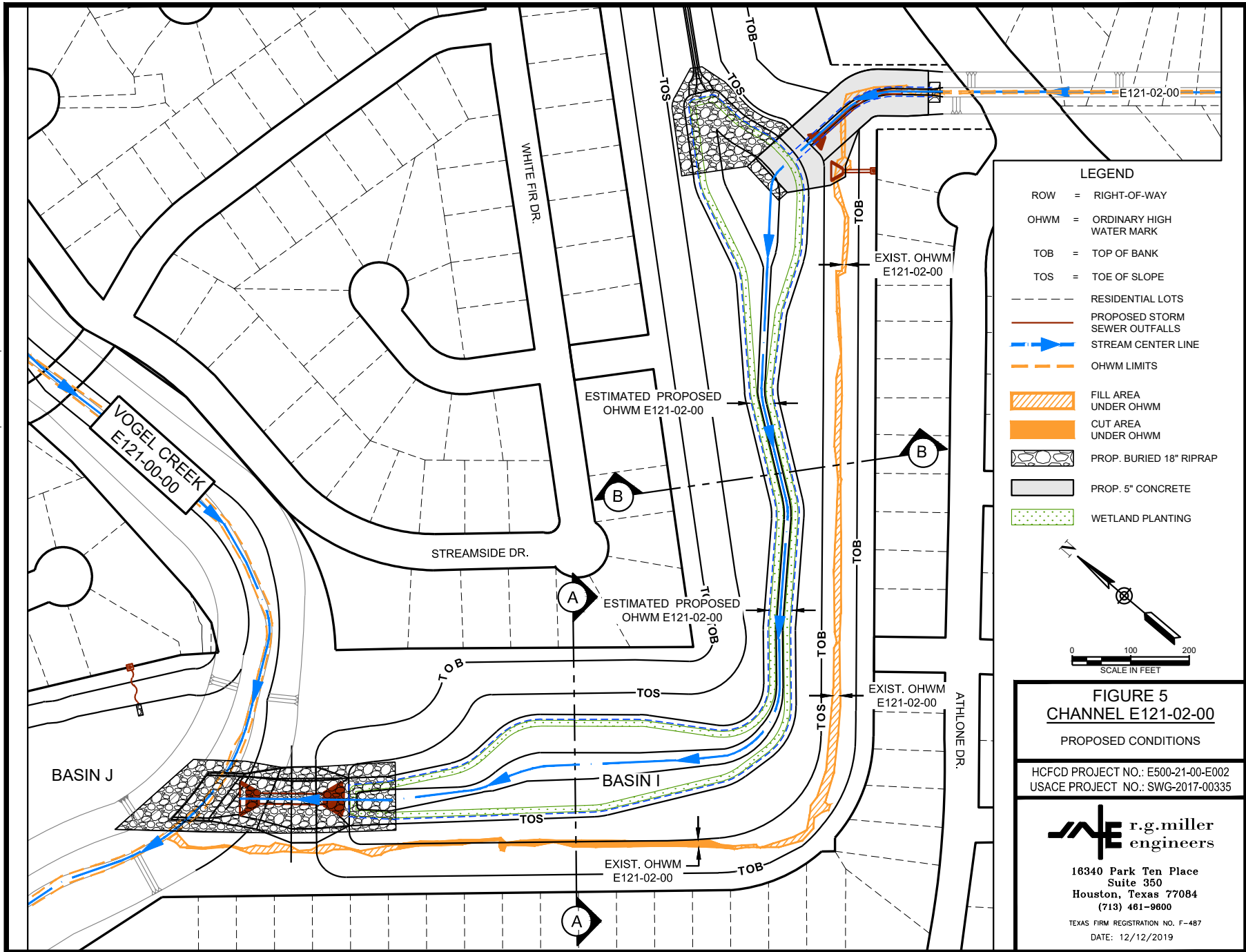

LEGEND

- ROW = RIGHT-OF-WAY
- OHWM = ORDINARY HIGH WATER MARK
- TOB = TOP OF BANK
- TOS = TOE OF SLOPE
- - - RESIDENTIAL LOTS
- PROPOSED STORM SEWER OUTFALLS
- STREAM CENTER LINE
- - - OHWM LIMITS
- ▨ FILL AREA UNDER OHWM
- ▨ CUT AREA UNDER OHWM
- ▨ PROP. BURIED 18" RIPRAP
- ▨ PROP. 5" CONCRETE
- ▨ WETLAND PLANTING

0 100 200
SCALE IN FEET

FIGURE 5
CHANNEL E121-02-00
PROPOSED CONDITIONS

HCFC D PROJECT NO.: E500-21-00-E002
USACE PROJECT NO.: SWG-2017-00335

r.g.miller
engineers

16340 Park Ten Place
Suite 350
Houston, Texas 77084
(713) 461-9800

TEXAS FIRM REGISTRATION NO. F-487
DATE: 12/12/2019

M:\BSET\INWOOD FOREST STORMWATER DETENTION\BASIN3\BSET_030_FINAL_DESIGN\CAD\EXHIBITS\USACE-EXIST CHANNEL & OUTFALL PROFILES.DWG | HCFCD & EXH1.CTB | PLOTTED: 12/12/2019

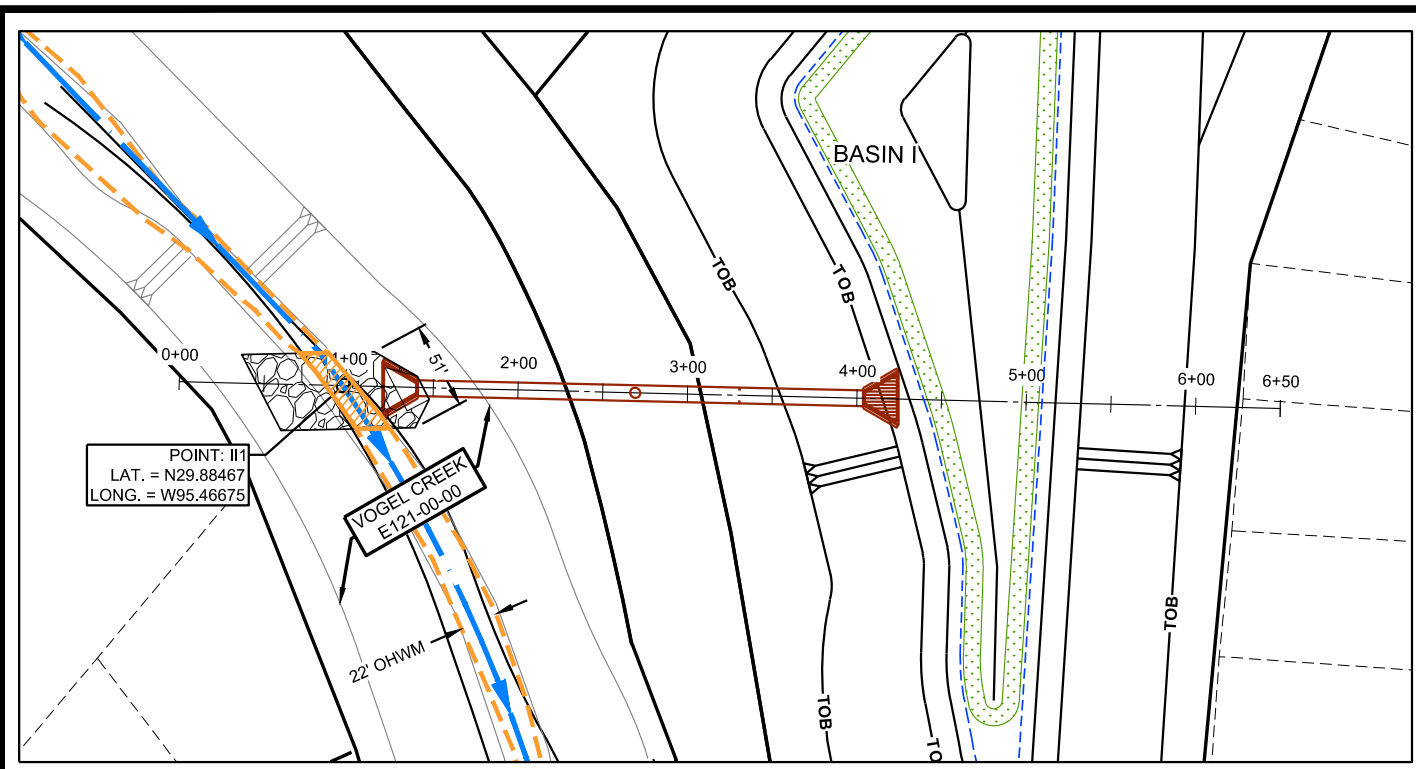

- LEGEND**
- ROW = RIGHT-OF-WAY
 - OHWM = ORDINARY HIGH WATER MARK
 - TOB = TOP OF BANK
 - TOS = TOE OF SLOPE
 - - - RESIDENTIAL LOTS
 - - - EXISTING GRADE
 - - - PROPOSED STORM SEWER OUTFALLS
 - STREAM CENTER LINE
 - - - OHWM LIMITS
 - ▨ FILL AREA UNDER OHWM
 - ▨ PROP. BURIED 18" RIPRAP
 - ▨ PROP. 5" CONCRETE
 - ▨ WETLAND PLANTING

| Basin I Inflow Structure North | |
|--------------------------------|----------------------|
| Fill Volumes | |
| Material | Volume (cubic yards) |
| Clear Dirt | 0 |
| Concrete | 0 |
| Concrete Rip-Rap | 59 |
| Total Volume | 59 |

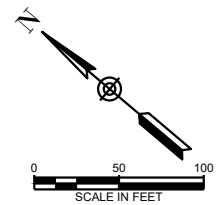
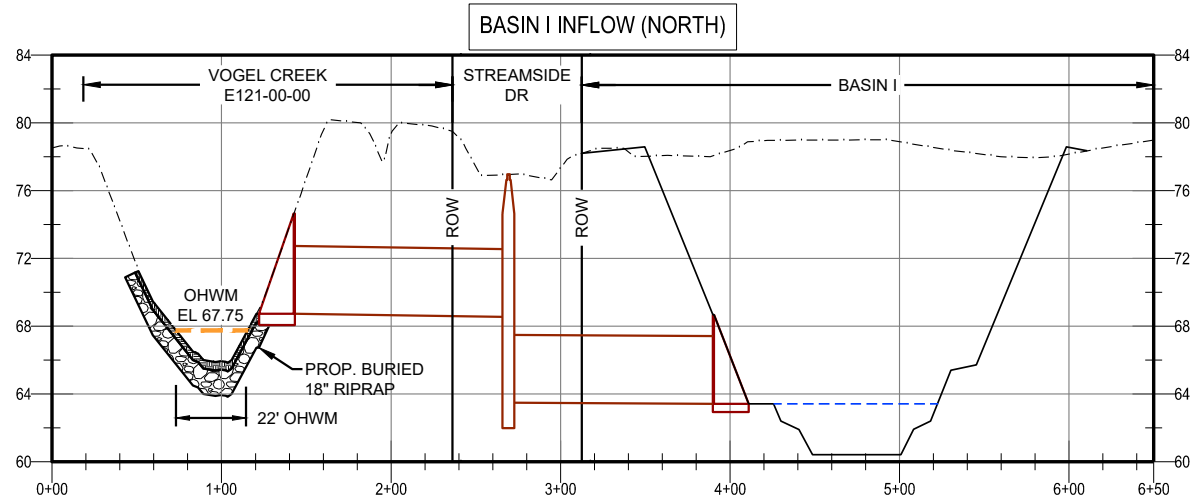



FIGURE 6
I11 - BASIN I
(NORTH - INFLOW STRUCTURE)

PROPOSED CONDITIONS

HCFCD PROJECT NO.: E500-21-00-E002
USACE PROJECT NO.: SWG-2017-00335



r.g. miller
engineers

16340 Park Ten Place
 Suite 350
 Houston, Texas 77084
 (713) 461-9800
 TEXAS FIRM REGISTRATION NO. F-487
 DATE: 12/12/2019

M:\BSET\INWOOD_FOREST\STORMWATER DETENTION BASIN\3651_030_FINAL DESIGN\CAD\EXHIBITS\USACE_EXIST CHANNEL & OUTFALL PROFILES.DWG | HCFCO & EXH1.CTB | PLOTTED: 12/12/2019

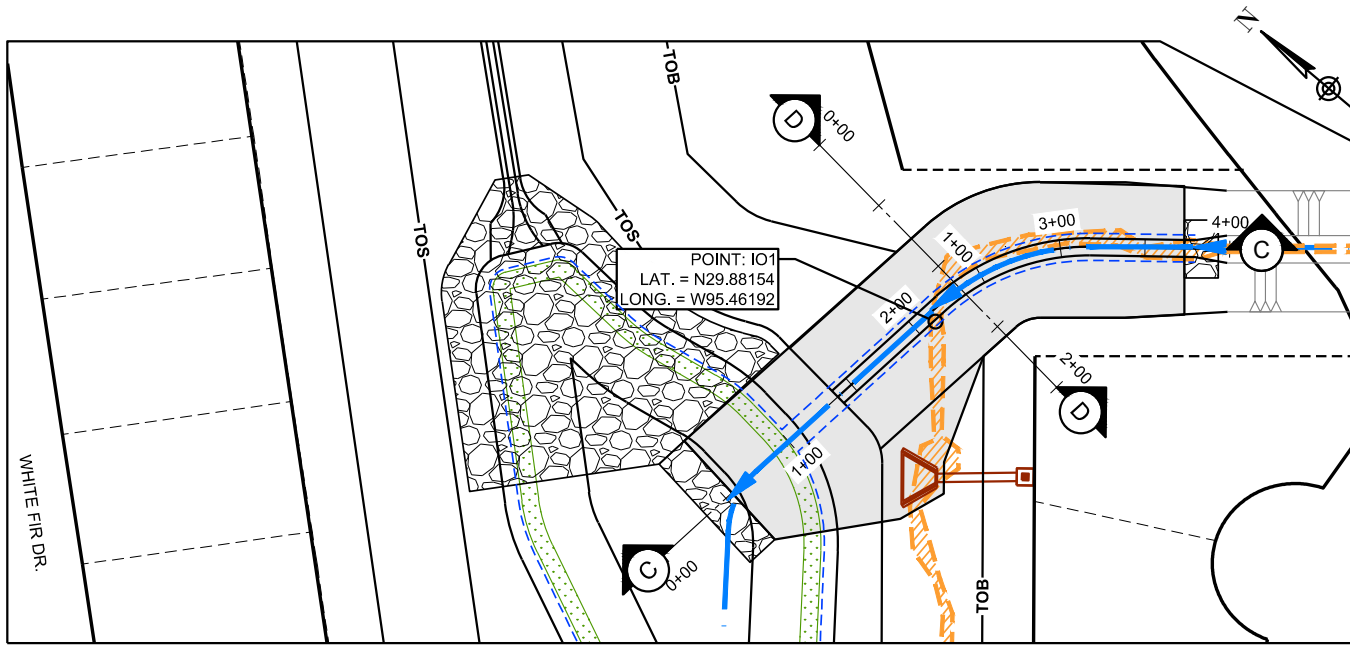

- LEGEND**
- ROW = RIGHT-OF-WAY
 - OHWM = ORDINARY HIGH WATER MARK
 - TOB = TOP OF BANK
 - TOS = TOE OF SLOPE
 - - - RESIDENTIAL LOTS
 - - - EXISTING GRADE
 - - - PROPOSED STORM SEWER OUTFALLS
 - ▶— STREAM CENTER LINE
 - - - OHWM LIMITS
 - ▨ FILL AREA UNDER OHWM
 - ▩ PROP. BURIED 18" RIPRAP
 - ▭ PROP. 5" CONCRETE
 - ▤ WETLAND PLANTING

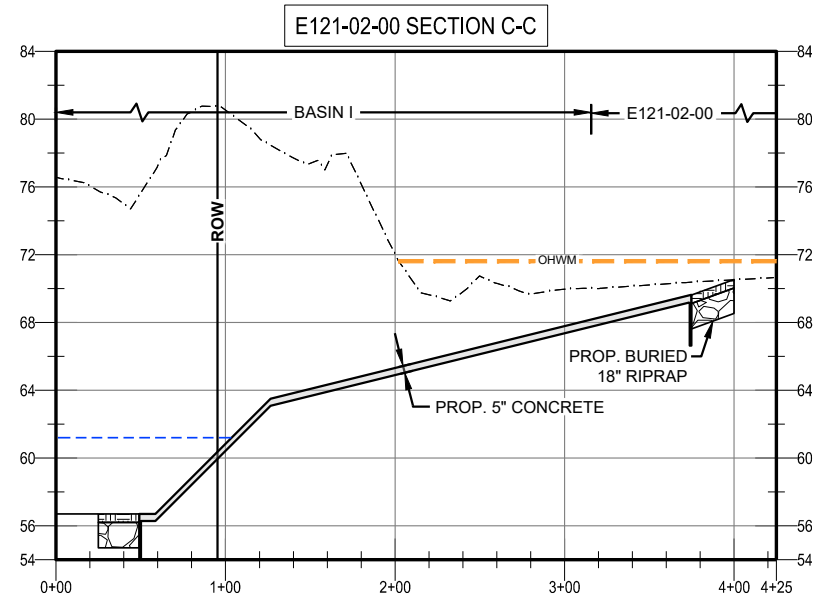
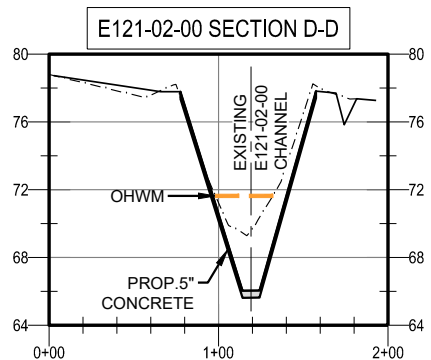

| Basin I (Including Outfall Structure 1) | |
|---|----------------------|
| Fill Volumes | |
| Material | Volume [cubic yards] |
| Clean Dir. | 343 |
| Concrete | 45 |
| Concrete Rip-Rap | 23 |
| Total Volume | 1003 |

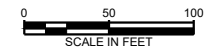



FIGURE 7
BASIN I AT E121-02-00

PROPOSED CONDITIONS

HCFCO PROJECT NO.: E500-21-00-E002
USACE PROJECT NO.: SWG-2017-00335



r.g. miller
engineers

16340 Park Ten Place
 Suite 350
 Houston, Texas 77084
 (713) 461-9800

TEXAS FIRM REGISTRATION NO. F-487
 DATE: 12/12/2019

M:\BSE1\INWOOD_FOREST_STORMWATER_RETENTION_BASINS\BSE1_030_FINAL_DESIGN\CAD\EXHIBITS\USACE_EXHIBIT_CHANNEL_AND_OUTFALL_PROFILES.DWG | HCFCO & EXH1.CTB | PLOTTED: 12/12/2019



LEGEND

- ROW = RIGHT-OF-WAY
- OHWM = ORDINARY HIGH WATER MARK
- TOB = TOP OF BANK
- TOS = TOE OF SLOPE
- - - RESIDENTIAL LOTS
- · - · - EXISTING GRADE
- - - PROPOSED STORM SEWER OUTFALLS
- STREAM CENTER LINE
- - - OHWM LIMITS
- [Hatched Box] FILL AREA UNDER OHWM
- [Solid Orange Box] CUT AREA UNDER OHWM
- [Riprap Pattern Box] PROP. BURIED 18" RIPRAP
- [Dotted Green Box] WETLAND PLANTING
- [Riprap Pattern Box] EXISTING RIPRAP

| Basin I Outfall Structure 2 | |
|-----------------------------|----------------------|
| Fill Volumes | |
| Material | Volume (cu/cy yards) |
| Clean Dirt | 0 |
| Concrete | 0 |
| Concrete Rip-Rap | 368 |
| Total Volume | 368 |

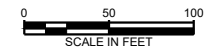
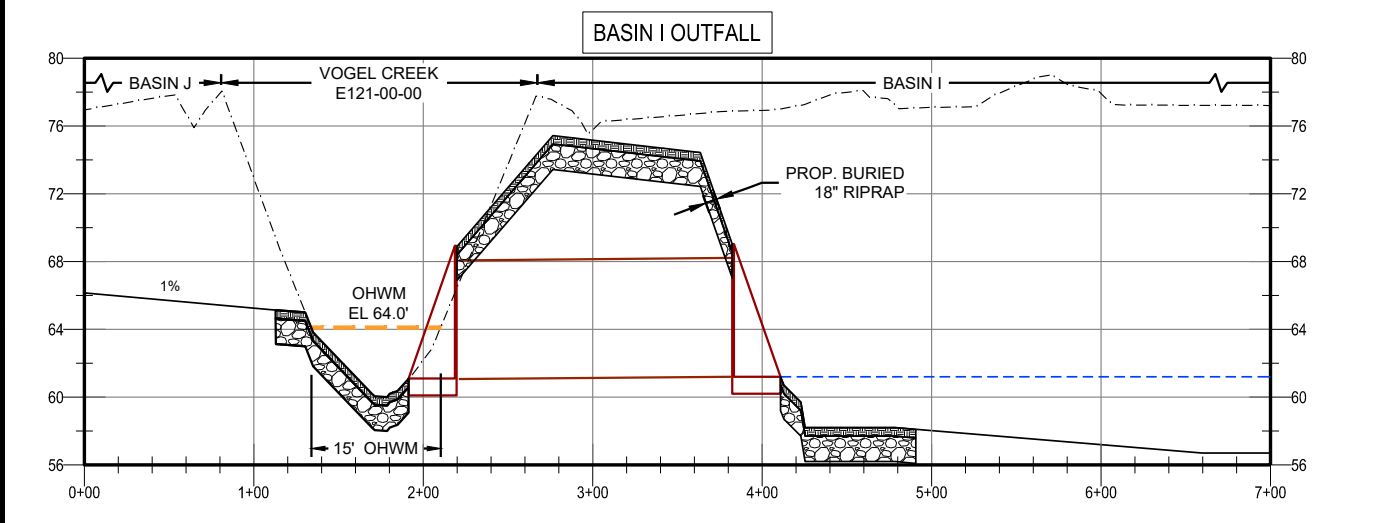

FIGURE 8
IO2 - BASIN I

PROPOSED CONDITIONS

HCFCO PROJECT NO.: E500-21-00-E002
USACE PROJECT NO.: SWG-2017-00335



r.g.miller
engineers

16340 Park Ten Place
 Suite 350
 Houston, Texas 77084
 (713) 461-9800

TEXAS FIRM REGISTRATION NO. F-487
 DATE: 12/12/2019

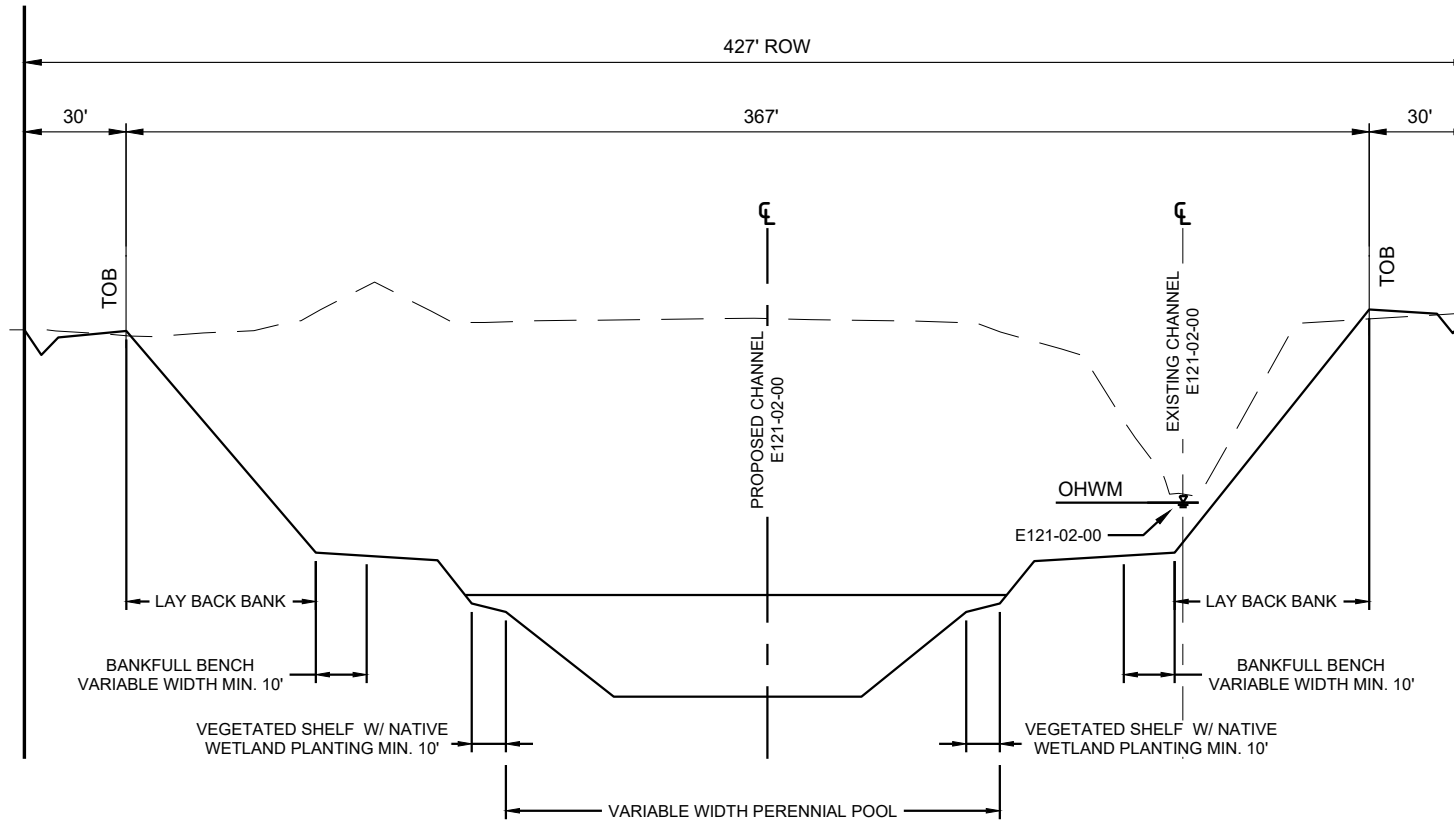

BASIN I TYPICAL SECTION A-A
N.T.S.

- LEGEND**
- TOB = TOP OF BANK
 - OHWM = ORDINARY HIGH WATER MARK
 - EXISTING GROUND
 - PROPOSED GROUND

FIGURE 9
BASIN I

TYPICAL SECTIONS

HCFCD PROJECT NO.: E500-21-00-E002
USACE PROJECT NO.: SWG-2017-00335



16340 Park Ten Place
Suite 350
Houston, Texas 77084
(713) 461-9800

TEXAS FIRM REGISTRATION NO. F-487
DATE: 12/12/2019

M:\BSET\INWOOD_FOREST\STORMWATER DETENTION\BASINS\BSET_030_FINAL_DESIGN\CAD\EXHIBITS\USACE-EXIST CHANNEL & OUTFALL PROFILES.DWG | HCFCD & EXH1.CTB | PLOTTED: 12/12/2019

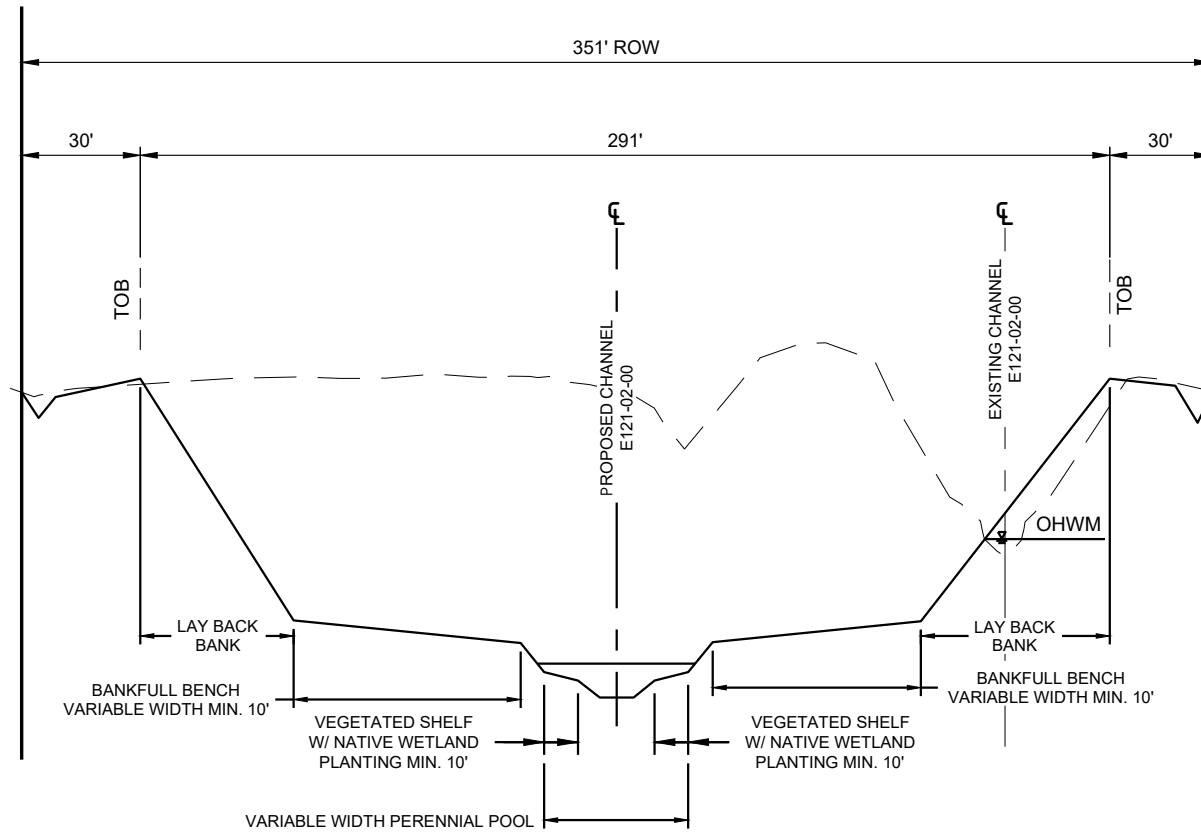

- LEGEND**
- TOB = TOP OF BANK
 - OHWM = ORDINARY HIGH WATER MARK
 - --- EXISTING GROUND
 - PROPOSED GROUND

BASIN I TYPICAL SECTION B-B
N.T.S.

FIGURE 10
BASIN I
TYPICAL SECTIONS

HCFC D PROJECT NO.: E500-21-00-E002
USACE PROJECT NO.: SWG-2017-00335

r.g.miller
engineers

16340 Park Ten Place
Suite 350
Houston, Texas 77084
(713) 461-9800

TEXAS FIRM REGISTRATION NO. F-487
DATE: 12/12/2019

M:\BSET\INWOOD_FOREST\STORMWATER DETENTION\BASINS\BSET_030_FINAL_DESIGN\CAD\EXHIBITS\USACE-EXIST CHANNEL & OUTFALL PROFILES.DWG | HCFC D & EXHIBIT B | PLOTTED: 12/12/2019

M:\BSET\INWOOD_FOREST\STORMWATER DETENTION\BASINS\3851_030_FINAL_DESIGN\CAD\EXHIBITS\USACE-EXIST CHANNEL & OUTFALL PROFILES.DWG | HCFCO & SKI.CTB | PLOTTED: 12/12/2019

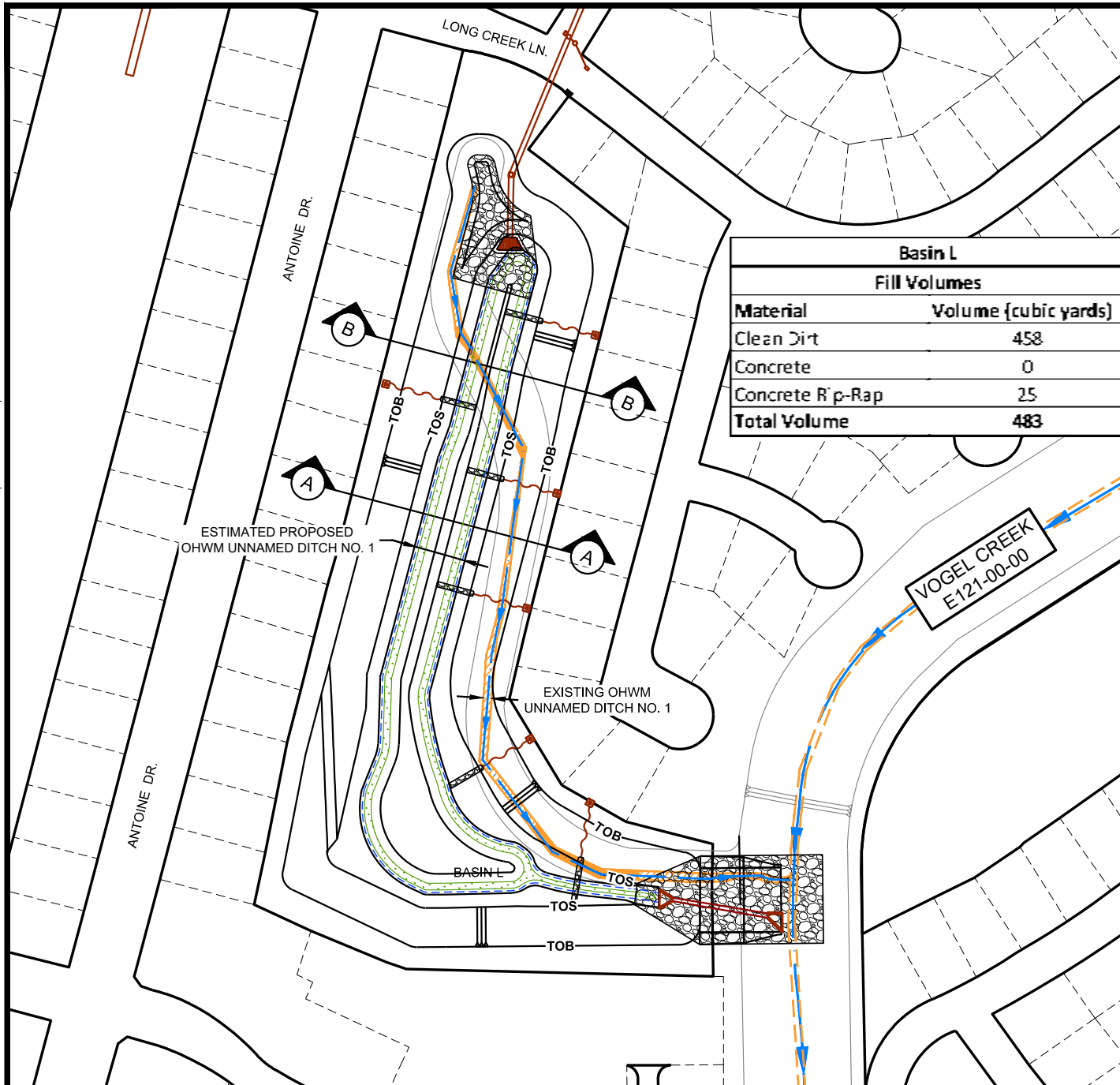

| Basin L | |
|---------------------|----------------------|
| Fill Volumes | |
| Material | Volume (cubic yards) |
| Clean Dirt | 458 |
| Concrete | 0 |
| Concrete R' p-Rap | 25 |
| Total Volume | 483 |

LEGEND

- ROW = RIGHT-OF-WAY
- OHWM = ORDINARY HIGH WATER MARK
- TOB = TOP OF BANK
- TOS = TOE OF SLOPE
- RESIDENTIAL LOTS
- PROPOSED STORM SEWER OUTFALLS
- STREAM CENTER LINE
- OHWM LIMITS
- FILL AREA UNDER OHWM
- CUT AREA UNDER OHWM
- PROP. BURIED 18" RIPRAP
- WETLAND PLANTING
- EXISTING RIPRAP

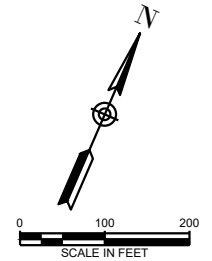
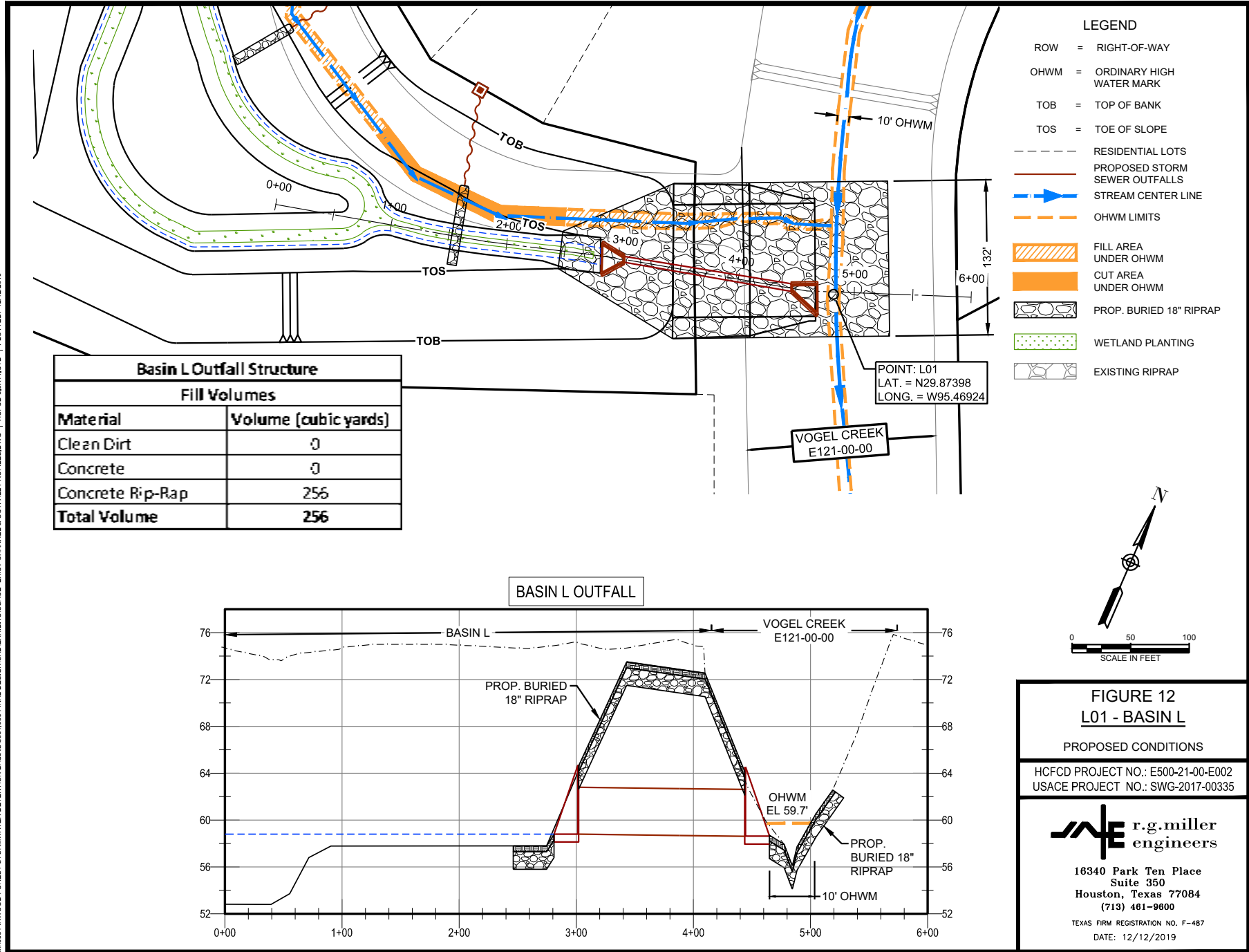

FIGURE 11
UNNAMED DITCH NO. 1

PROPOSED CONDITIONS

HCFCO PROJECT NO.: E500-21-00-E002
USACE PROJECT NO.: SWG-2017-00335

16340 Park Ten Place
 Suite 350
 Houston, Texas 77084
 (713) 461-9800
 TEXAS FIRM REGISTRATION NO. F-487
 DATE: 12/12/2019



M:\BSET\INWOOD_FOREST\STORMWATER\DETENTION\BASINS\3851_030_FINAL_DESIGN\CAD\EXHIBITS\USACE-EXIST_CHANNEL_&_OUTFALL_PROFILES.DWG | HCFCO_8.6X11_CTB | PLOTTED: 12/12/2019

FIGURE 12
L01 - BASIN L

PROPOSED CONDITIONS

HCFCO PROJECT NO.: E500-21-00-E002
USACE PROJECT NO.: SWG-2017-00335

r.g.miller
engineers

16340 Park Ten Place
Suite 350
Houston, Texas 77084
(713) 461-9800

TEXAS FIRM REGISTRATION NO. F-487
DATE: 12/12/2019

M:\BSE1\INWOOD FOREST STORMWATER DETENTION BASIN\BSE1_030_FINAL_DESIGN\CAD\EXHIBITS\USACE-EXIST CHANNEL & OUTFALL PROFILES.DWG | HCFC D & EXHIBIT B | PLOTTED: 12/12/2019

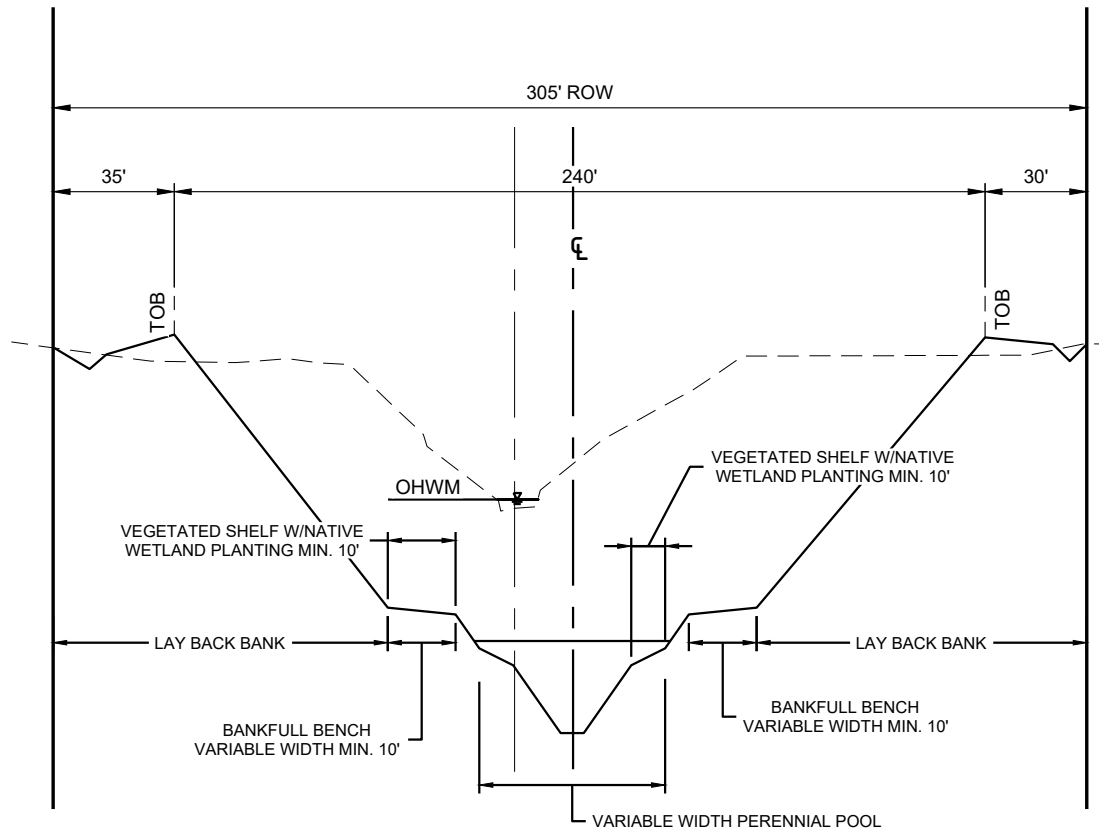

BASIN L TYPICAL SECTION A-A
N.T.S.

- LEGEND**
- TOB = TOP OF BANK
 - OHWM = ORDINARY HIGH WATER MARK
 - - - EXISTING GROUND
 - PROPOSED GROUND

FIGURE 13
BASIN L
TYPICAL SECTIONS

HCFC D PROJECT NO.: E500-21-00-E002
USACE PROJECT NO.: SWG-2017-00335

r.g.miller
engineers

16340 Park Ten Place
Suite 350
Houston, Texas 77084
(713) 461-9800

TEXAS FIRM REGISTRATION NO. F-487
DATE: 12/12/2019

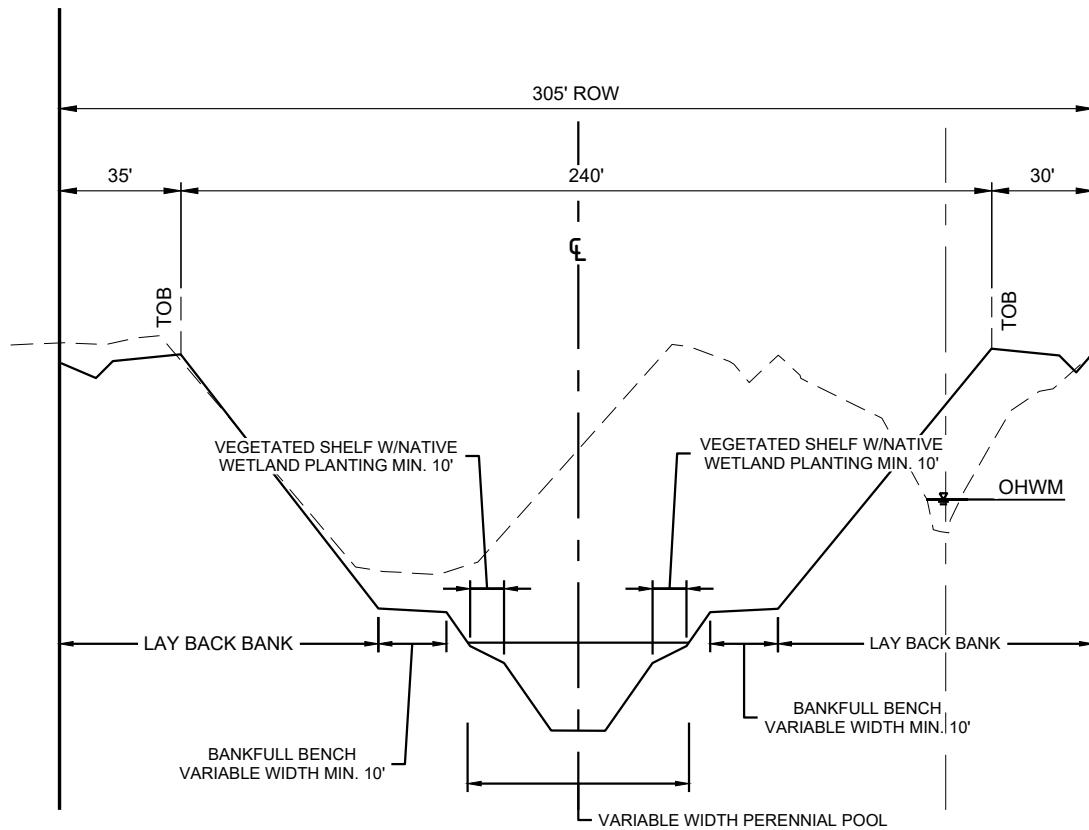

- LEGEND**
- TOB = TOP OF BANK
 - OHWM = ORDINARY HIGH WATER MARK
 - - - - EXISTING GROUND
 - PROPOSED GROUND

BASIN L TYPICAL SECTION B-B
N.T.S.

FIGURE 14
BASIN L
TYPICAL SECTIONS

HCFCO PROJECT NO.: E500-21-00-E002
USACE PROJECT NO.: SWG-2017-00335

**r.g. miller
engineers**

16340 Park Ten Place
Suite 350
Houston, Texas 77084
(713) 461-9800

TEXAS FIRM REGISTRATION NO. F-487
DATE: 12/12/2019

M:\BSE1\INWOOD_FOREST STORMWATER DETENTION BASINS\BSE1_030_FINAL_DESIGN\CAD\EXHIBITS\USACE-EXIST CHANNEL & OUTFALL PROFILES.DWG | HCFCO & EXH1.CTB | PLOTTED: 12/12/2019

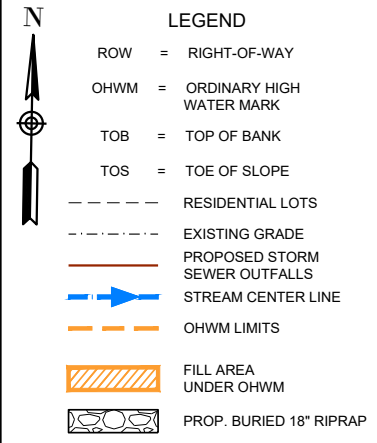
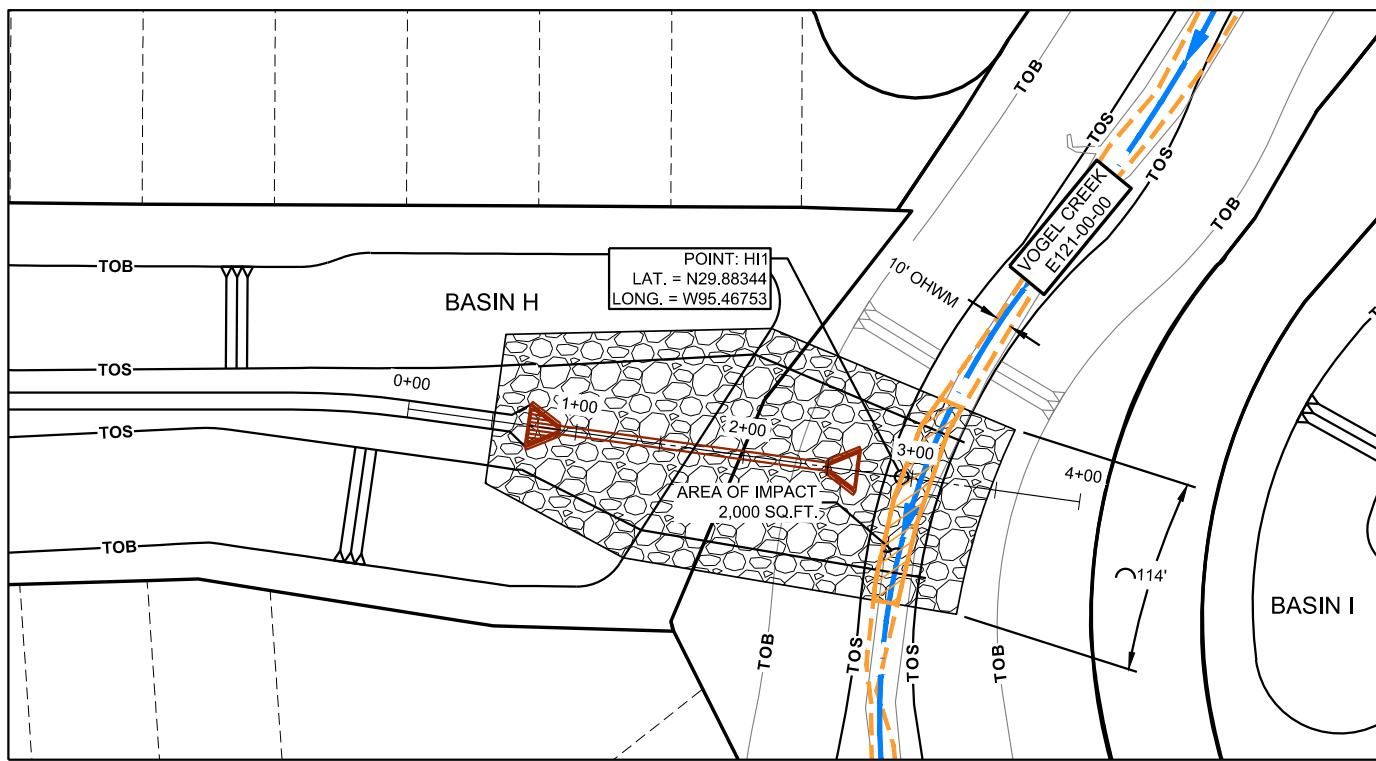

| Basin H Inflow Structure | |
|--------------------------|----------------------|
| Fill Volumes | |
| Material | Volume (cubic yards) |
| Clear Dirt | 3 |
| Concrete | 3 |
| Concrete Riprap | 51 |
| Total Volume | 57 |

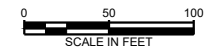
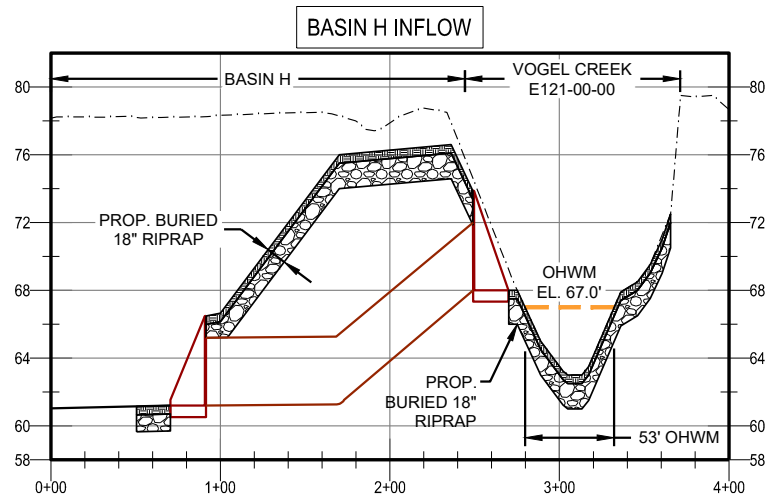

FIGURE 15
H11 - BASIN H
(INFLOW)

PROPOSED CONDITIONS

HCFCO PROJECT NO.: E500-21-00-E002
USACE PROJECT NO.: SWG-2017-00335

r.g. miller
engineers

16340 Park Ten Place
Suite 350
Houston, Texas 77084
(713) 461-9800

TEXAS FIRM REGISTRATION NO. F-487
DATE: 12/12/2019

M:\BSET\INWOOD FOREST STORMWATER DETENTION BASINS\BSET_030 FINAL DESIGN\CAD\EXHIBITS\USACE-EXIST CHANNEL & OUTFALL PROFILES.DWG | HCFCO & EXH1.CTB | PLOTTED: 12/12/2019